

LEGEND :

- | | | |
|--|---|---|
| <p>CB CAVITY BATTEN: 45x20 KLC Generation II, MicroPro H3.2 FJ Cavity Batten to form a 20mm cavity</p> <p>IL INTERNAL LINING: Selected Internal Lining</p> <p>BW BUILDING WRAP: Flexible Wall Underlay, As per NZBC E2/AS1 - Table 23, In extra high wind zones, Ridgid Underlay required (9.1.7.2 E2/AS1)</p> <p>CS CORNER SOAKER: With 15mm Min cover over weatherboards</p> | <p>FT3 FLEXIBLE FLASHING TAPE: Flexible flashing tape lapped into corner</p> <p>TF TIMBER FRAME: H1.2 min treated timber framing</p> <p>WB WEATHER BOARD: KLC Generation II, MicroPro H3.2 Bevel Back Weatherboard, Profile to NZS 3617</p> <p>IN INSULATION: Selected Insulation</p> | <p>CF CORNER FLASHING: Aluminium, PVC or Stainless Steel corner flashing. Refer NZBC E2/AS1 4.3 50x50 Hem or Hook to Flashing Edges 75x75 NO. Hem or Hook Required EXTRA HIGH WIND ZONE 100x100 Hem or Hook to Flashing Edges, Refer NZBC E2/AS1 4.5.1</p> |
|--|---|---|

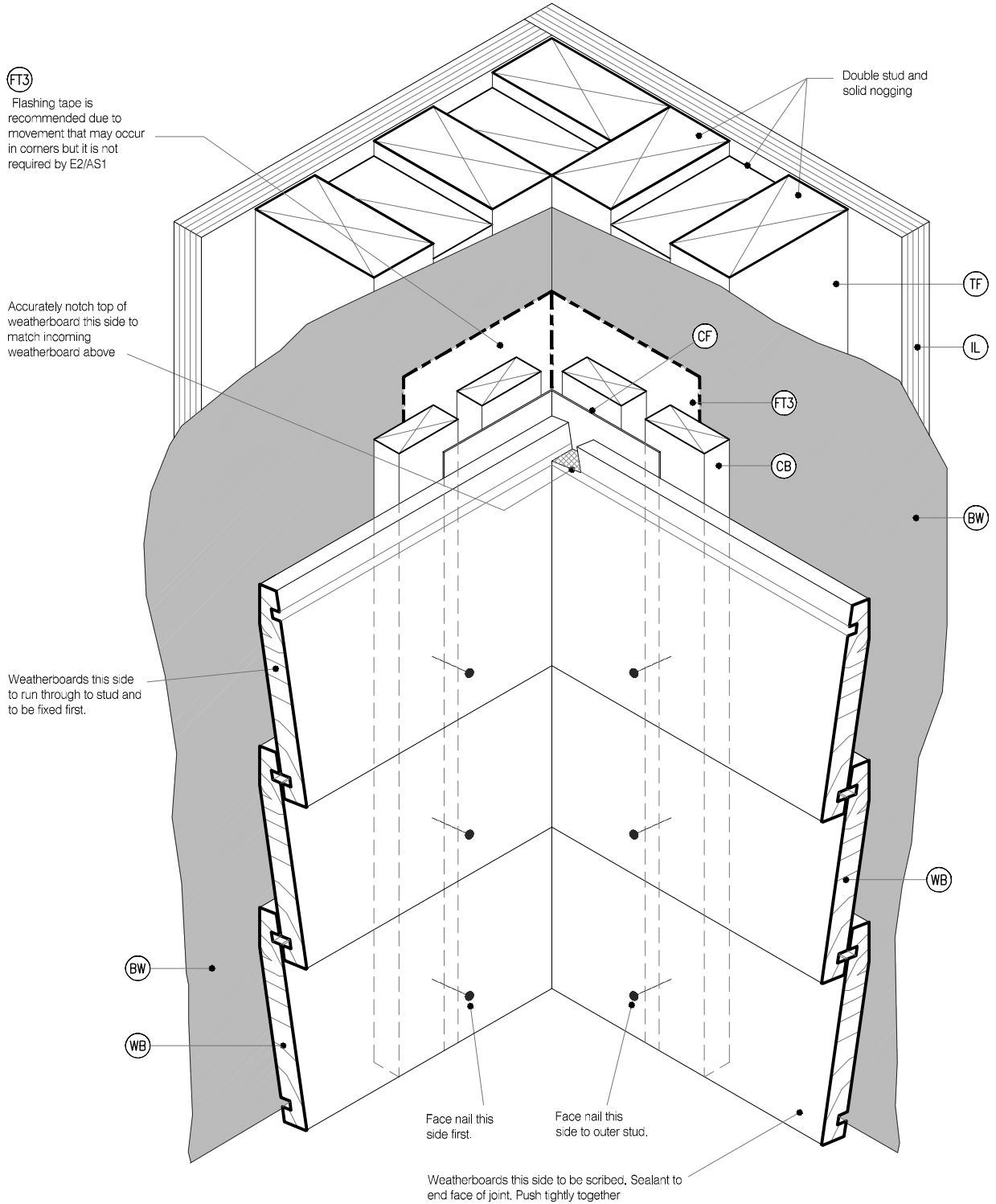

MicoPro® Wood Treatment Technology

- KLC use the MicroPro Micronized Copper Azole (MCA) based preservative system for their wood products. It accounts for 80% of wood treated in the US for domestic applications.
- Micronized Copper Azole (MCA) preservatives are EPA-approved for use in NZ and AUS to NZS3640:2003 and AS1604:12012
- MicroPro preservative is applied using high-pressure and vacuum-pressure in the impregnation process in KLC's modern, automated treatment facility.
- Cut End Treatment: All cut ends surfaces are to be double coated and sealed before fixing. With a alkylid (oil based) primer
- MicroPro preservative solution has benefits of reduced corrosivity. Use Hot Dip Galvanised Fasteners & Stainless Steel fasteners. MicroPro may be placed in direct contact with Aluminium Building products in interior applications, and above ground exterior applications that provide proper water drainage
- MicroPro® is the first wood treatment process to be EPP (Environmentally Preferable Product) certified by Scientific Certification Systems based on a life cycle assessment.
- MicroPro® is environmentally sustainable, is low leaching, low VOC emissions and the award of the GREENGUARD Children and Schools Certification from the Greenguard® Environmental Institute.
- MicroPro® Wood Treatment Technology has received a Global GreenTag GreenRate™ Level A this declaration is 'fit-for-purpose' and confirmed for Green Building compliance.
- MicroPro® Wood Treatment Technology has received GreenTag PhD™ proving claims that MicroPro® is safe for human health (and ecosystems).

CAD REF :KLC CF20 BB40-46 - GENERAL DETAILS 01.dwg
DATE :18/10/2018



TYPE **Generation II H3.2 Exterior Cladding Systems**
Bevel Back Weatherboard - Cavity Fix

www.klc.co.nz
DETAILS MAY BE SUBJECT TO CHANGE WITHOUT NOTICE
COPYRIGHT © "KLC LIMITED" ALL RIGHTS ASSERTED

NAME 3D - Internal Corner



DRAWING SCALE 1:2 @ A4	ISSUE DATE 18/10/2018
DRAWING No KLC CF20 BB43	REVISION 1