

LEGEND :

- |   |   |   |
|---|---|---|
| <ul style="list-style-type: none"> <li>(PEF) PEF ROD BACKING: Foam backing rod with sealant to perimeter that forms a waterproof air-seal. ( Sealant 2:1 Ratio )</li> <li>(IL) INTERNAL LINING: Selected Internal Lining</li> <li>(BW) BUILDING WRAP: Flexible Wall Underlay, As per NZBC E2/AS1 - Table 23. In extra high wind zones, Rigid Underlay required ( 9.1.7.2 E2/AS1 )</li> <li>(IN) INSULATION: Selected Insulation</li> <li>(TF) TIMBER FRAME: H1.2 min treated timber framing</li> <li>(WB) WEATHER BOARD: KLC Generation II, MicroPro H3.2 Vertical Shiplap WB. Profile to NZS 3617</li> </ul> | <ul style="list-style-type: none"> <li>(FT3) FLEXIBLE FLASHING TAPE: Flexible flashing tape lapped into corner, Refer NZBC E2/AS1 4.3.11 Flashing tape is recommended due to movement that may occur in corners but it is not required by E2/AS1</li> <li>(FT4) FLEXIBLE FLASHING TAPE: Flexible flashing tape wrapped around pipe and over building wrap, Refer NZBC E2/AS1 4.3.11 &amp; Figure 68</li> <li>(BC1) BOXED CORNER COVER : 98x18 KLC Generation II, MicroPro H3.2 Cover Batten to boxed corners</li> <li>(BC2) BOXED CORNER COVER: 85x18 KLC Generation II, MicroPro H3.2 Cover Batten to boxed corners</li> </ul> | <ul style="list-style-type: none"> <li>(CB1) CAVITY BATTEN, HORIZONTAL: 45x20 Castellated with a 18 degree bevelled slope. MicroPro H3.2 FJ. To form a 20mm cavity</li> <li>(CB2) CAVITY BATTEN, VERTICAL: 45x20 KLC Generation II, MicroPro H3.2 FJ. To form a 20mm cavity</li> <li>(CF) CORNER FLASHING: Aluminium, PVC or Stainless Steel corner flashing. Refer NZBC E2/AS1 4.3 50x50 Hem or Hook to Flashing Edges 75x75 NO. Hem or Hook Required EXTRA HIGH WIND ZONE 100x100 Hem or Hook to Flashing Edges, Refer NZBC E2/AS1 4.5.1</li> </ul> |
|---|---|---|

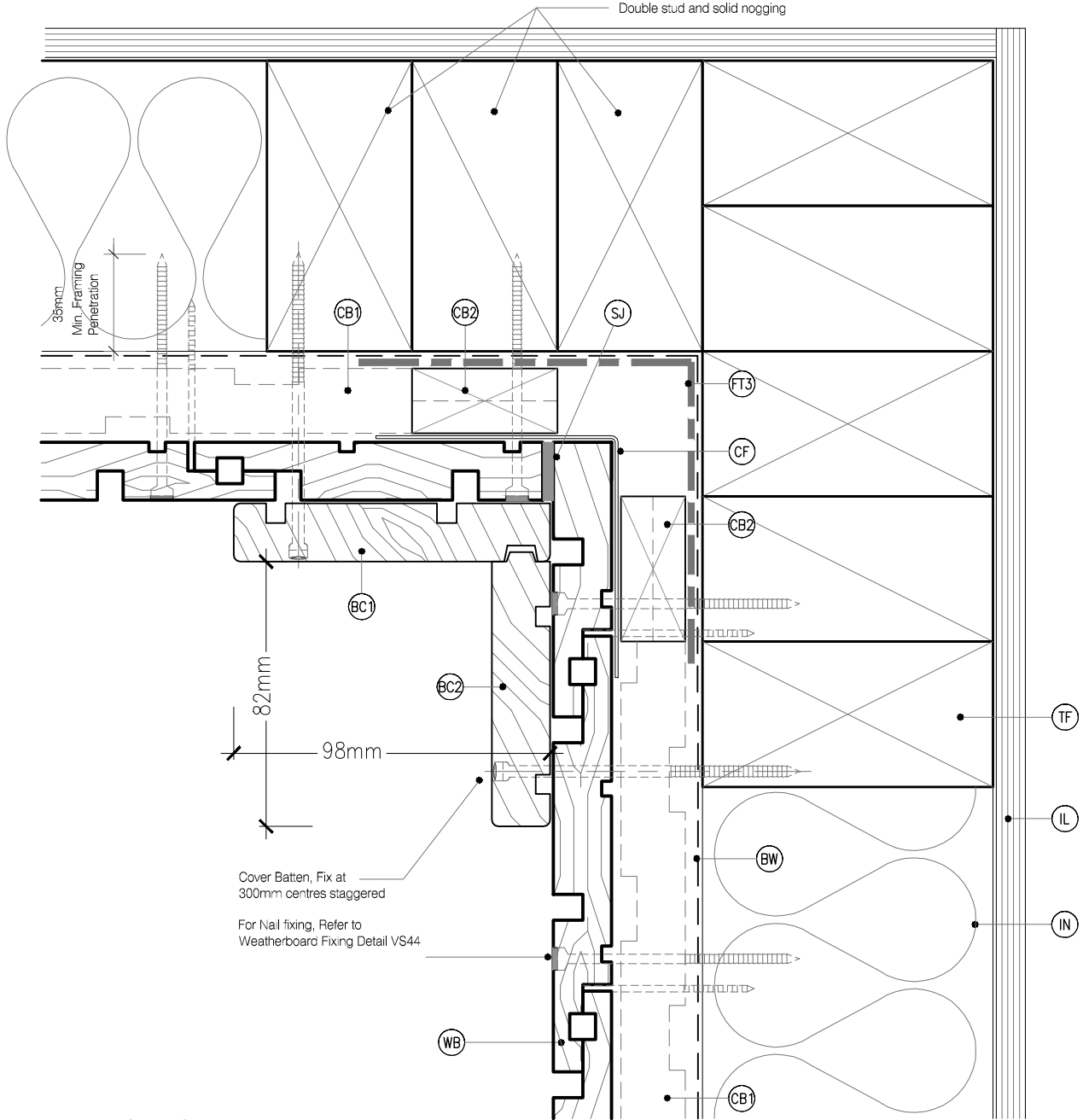

DETAIL NOTES :

1. Flashing tape is recommended due to movement that may occur in corners but it is not required by E2/AS1
  2. Aluminium extrusion must not be continuous over solid floor joists.
- MicoPro® Wood Treatment Technology**

- |   |   |   |
|---|---|---|
| <ol style="list-style-type: none"> <li>1. KLC use the MicroPro Micronized Copper Azole ( MCA ) based preservative system for their wood products. It accounts for 80% of wood treated in the US for domestic applications.</li> <li>2. Micronized Copper Azole ( MCA ) preservatives are EPA-approved for use in NZ and AUS to NZS3640:2003 and AS1604:12012</li> <li>3. MicroPro preservative is applied using high-pressure and vacuum-pressure in the impregnation process in KLC's modern, automated treatment facility.</li> <li>4. Cut End Treatment : All cut ends surfaces are to be double coated and sealed before fixing. With a alkyl ( oil based ) primer</li> </ol> | <ol style="list-style-type: none"> <li>5. MicroPro preservative solution has benefits of reduced corrosivity. Use Hot Dip Galvanised Fasteners &amp; Stainless Steel fasteners. MicroPro may be placed in direct contact with Aluminium Building products in interior applications, and above ground exterior applications that provide proper water drainage</li> <li>6. MicroPro® is the first wood treatment process to be EPP ( Environmentally Preferable Product ) certified by Scientific Certification Systems based on a life cycle assessment.</li> </ol> | <ol style="list-style-type: none"> <li>7. MicroPro® is environmentally sustainable, is low leaching, low VOC emissions and the award of the GREENGUARD Children and Schools Certification from the Greenguard® Environmental Institute.</li> <li>8. MicroPro® Wood Treatment Technology has received a Global GreenTag GreenRate™ Level A this declaration is 'fit-for-purpose' and confirmed for Green Building compliance.</li> <li>9. MicroPro® Wood Treatment Technology has received GreenTag PhD™ proving claims that MicroPro® is safe for human health (and ecosystems).</li> </ol> |
|---|---|---|

CAD REF :KLC CF20 VS50-56 - GENERAL DETAILS 02.dwg  
DATE :26/10/2018



TYPE **Generation II H3.2 Exterior Cladding Systems**  
**Vertical Shiplap WB - Cavity Fix**

NAME **Internal Boxed Corner**

[www.klc.co.nz](http://www.klc.co.nz)  
DETAILS MAY BE SUBJECT  
TO CHANGE WITHOUT NOTICE  
COPYRIGHT © "KLC LIMITED" ALL RIGHTS ASSERTED



DRAWING SCALE 1:2 @ A4	ISSUE DATE 26/10/2018
DRAWING No <b>KLC CF20 VS52</b>	REVISION