

LEGEND :

- CB** CAVITY BATTEN: 45x20 KLC Generation II, MicroPro H3.2 FJ Cavity Batten to form a 20mm cavity
- IL** INTERNAL LINING: Selected Internal Lining
- BW** BUILDING WRAP: Flexible Wall Underlay, As per NZBC E2/AS1 - Table 23, In extra high wind zones, Rigid Underlay required (9.1.7.2 E2/AS1)
- IN** INSULATION: Selected Insulation
- TF** TIMBER FRAME: H:1.2 min treated timber framing

- FT2** FLEXIBLE FLASHING TAPE: Additional underlay of flexible flashing tape lapped over Apron flashing
- WB** WEATHER BOARD: KLC Generation II, MicroPro H3.2 Bevel Back Weatherboard. Profile to NZS 3617
- MR** METAL ROOFING : Selected Metal Roofing
- RU** ROOFING UNDERLAY: Selected Roofing Underlay As Per AS/AZS4200 with Mesh or Self Supported
- TP** TIMBER PACKER: Cant Strip, MicroPro H3.2 Treated

- HS** HEAD SOFFIT SCRIBER: KLC Generation II, MicroPro H3.2. Fix with 75 x 3.15mm Galvanised nail in 3mm predrilled hole
- AF** APRON FLASHING: Materials as per E2/AS1 4.0, Coating to match roofing material or refer E2/AS1 Table 21. Flashing Cover 130mm min. (L, M & H ≥ 10°) All others 200mm Refer Table 7 E2/AS1
- SL** SOFFIT LINING: As Selected (Typically 7.5mm Hardies Soffit Liner)

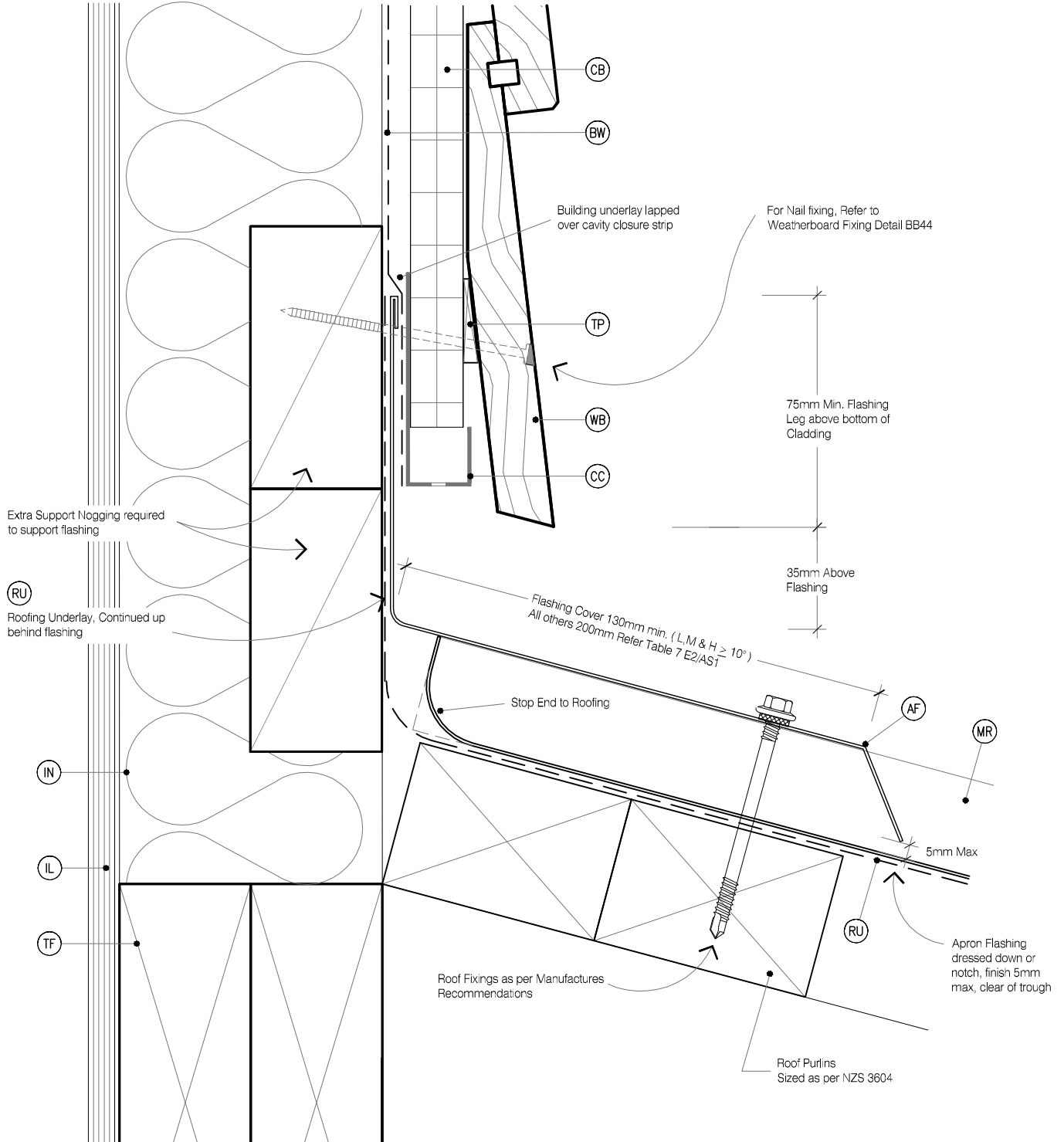

MicroPro® Wood Treatment Technology

1. KLC use the MicroPro Micronized Copper Azole (MCA) based preservative system for their wood products. It accounts for 80% of wood treated in the US for domestic applications.
2. Micronized Copper Azole (MCA) preservatives are EPA-approved for use in NZ and AUS to NZS3640:2003 and AS1604:12012
3. MicroPro preservative is applied using high-pressure and vacuum-pressure in the impregnation process in KLC's modern, automated treatment facility.
4. Cut End Treatment: All cut ends surfaces are to be double coated and sealed before fixing. With a alkylid (oil based) primer
5. MicroPro preservative solution has benefits of reduced corrosivity. Use Hot Dip Galvanised Fasteners & Stainless Steel fasteners. MicroPro may be placed in direct contact with Aluminium Building products in interior applications, and above ground exterior applications that provide proper water drainage.
6. MicroPro® is the first wood treatment process to be EPP (Environmentally Preferable Product) certified by Scientific Certification Systems based on a life cycle assessment.
7. MicroPro® is environmentally sustainable, is low leaching, low VOC emissions and the award of the GREENGUARD Children and Schools Certification from the Greenguard® Environmental Institute.
8. MicroPro® Wood Treatment Technology has received a Global GreenTag GreenRate™ Level A this declaration is 'fit-for-purpose' and confirmed for Green Building compliance.
9. MicroPro® Wood Treatment Technology has received GreenTag PhD™ proving claims that MicroPro® is safe for human health (and ecosystems).

CAD REF :KLC CF20 BB60-66 - GENERAL DETAILS 03.dwg
DATE :18/10/2018



TYPE **Generation II H3.2 Exterior Cladding Systems**
Bevel Back Weatherboard - Cavity Fix

NAME **Apron Flashing - Roof to Wall Junction**

www.klc.co.nz
DETAILS MAY BE SUBJECT TO CHANGE WITHOUT NOTICE
COPYRIGHT © "KLC LIMITED" ALL RIGHTS ASSERTED



DRAWING SCALE 1:2 @ A4	ISSUE DATE 18/10/2018
DRAWING No KLC CF20 BB64	REVISION 1