

LEGEND :

- | | | |
|---|--|---|
| <p>(WB) WEATHER BOARD: KLC Generation II, MicroPro H3.2 Vertical Shiplap WB, Profile to NZS 3617</p> <p>(IL) INTERNAL LINING: Selected Internal Lining</p> <p>(BW) BUILDING WRAP: Flexible Wall Underlay, As per NZBC E2/AS1 - Table 23, In extra high wind zones, Rigid Underlay required (9.1.7.2 E2/AS1)</p> <p>(IN) INSULATION: Selected Insulation</p> | <p>(FT3) FLEXIBLE FLASHING TAPE: Flexible flashing tape lapped into corner, Refer NZBC E2/AS1 4.3.11 Flashing tape is recommended due to movement that may occur in corners but it is not required by E2/AS1</p> <p>(TF) TIMBER FRAME: H1.2 min treated timber framing</p> <p>(CB1) CAVITY BATTEN, HORIZONTAL: 45x20 Castellated with a 18 degree bevelled slope. MicroPro H3.2 FJ. To form a 20mm cavity</p> | <p>(CF) CORNER FLASHING: Aluminium, PVC or Stainless Steel corner flashing. Refer NZBC E2/AS1 4.3 50x50 Hem or Hook to Flashing Edges 75x75 NO. Hem or Hook Required EXTRA HIGH WIND ZONE 100x100 Hem or Hook to Flashing Edges, Refer NZBC E2/AS1 4.5.1</p> <p>(CB2) CAVITY BATTEN, VERTICAL: 45x20 KLC Generation II, MicroPro H3.2 FJ. To form a 20mm cavity</p> |
|---|--|---|

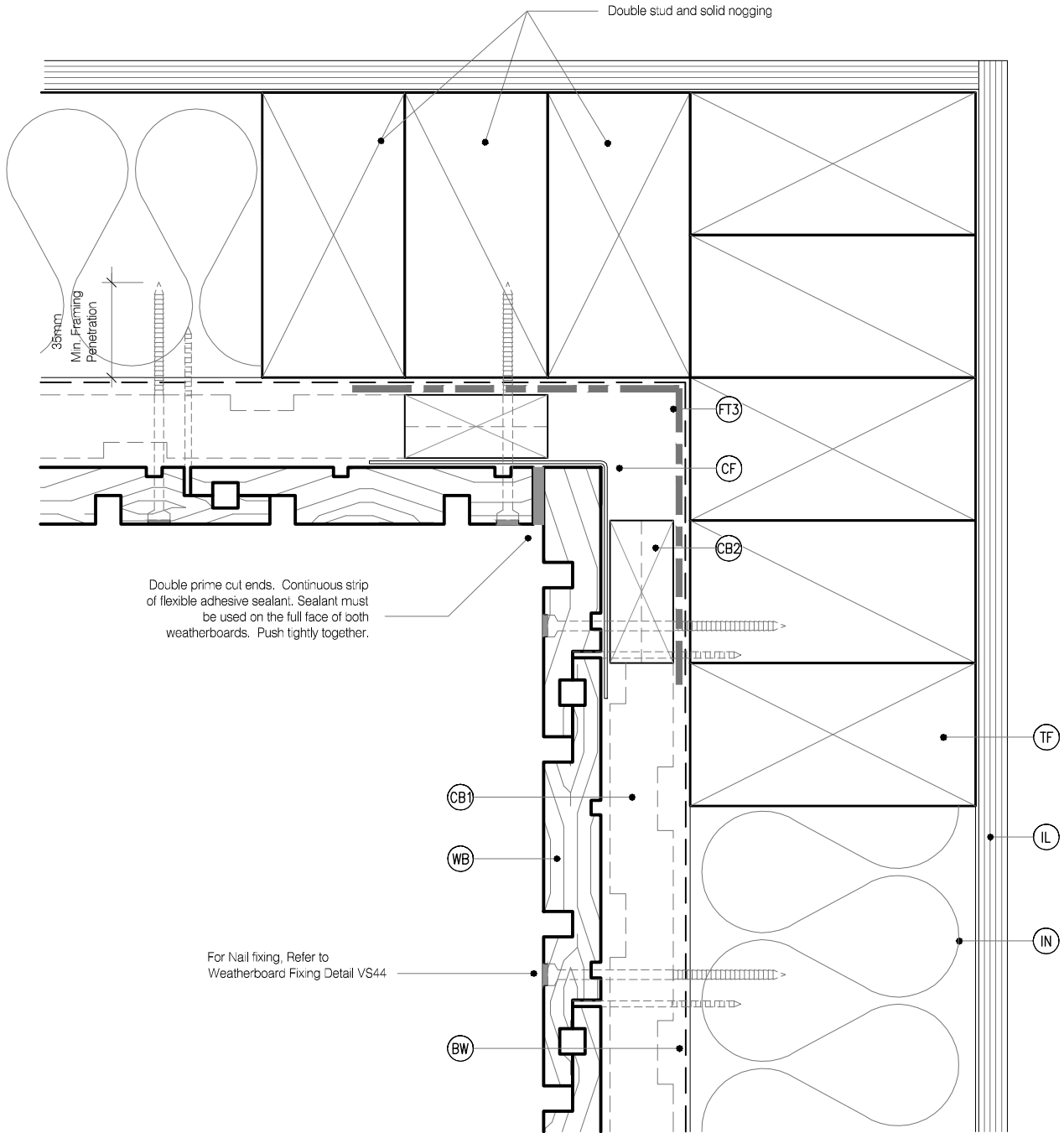

DETAIL NOTES :

1. Flashing tape is recommended due to movement that may occur in corners but it is not required by E2/AS1
2. Aluminium extrusion must not be continuous over solid floor joists.

MicoPro® Wood Treatment Technology

- | | | |
|---|---|---|
| <ol style="list-style-type: none"> 1. KLC use the MicroPro Micronized Copper Azole (MCA) based preservative system for their wood products. It accounts for 80% of wood treated in the US for domestic applications. 2. Micronized Copper Azole (MCA) preservatives are EPA-approved for use in NZ and AUS to NZS3640:2003 and AS1604:12012 3. MicroPro preservative is applied using high-pressure and vacuum-pressure in the impregnation process in KLC's modern, automated treatment facility. 4. Cut End Treatment : All cut ends surfaces are to be double coated and sealed before fixing. With a alkyl (oil based) primer | <ol style="list-style-type: none"> 5. MicroPro preservative solution has benefits of reduced corrosivity. Use Hot Dip Galvanised Fasteners & Stainless Steel fasteners. MicroPro may be placed in direct contact with Aluminium Building products in interior applications, and above ground exterior applications that provide proper water drainage 6. MicroPro® is the first wood treatment process to be EPP (Environmentally Preferable Product) certified by Scientific Certification Systems based on a life cycle assessment. | <ol style="list-style-type: none"> 7. MicroPro® is environmentally sustainable, is low leaching, low VOC emissions and the award of the GREENGUARD Children and Schools Certification from the Greenguard® Environmental Institute. 8. MicroPro® Wood Treatment Technology has received a Global GreenTag GreenRate™ Level A this declaration is 'Fit-for-Purpose' and confirmed for Green Building compliance. 9. MicroPro® Wood Treatment Technology has received GreenTag PhD™ proving claims that MicroPro® is safe for human health (and ecosystems). |
|---|---|---|

CAD REF : KLC CF20 VS40-46 - GENERAL DETAILS 01.dwg
DATE : 25/10/2018



TYPE **Generation II H3.2 Exterior Cladding Systems Vertical Shiplap WB - Cavity Fix**

NAME **Internal Corner**

www.klc.co.nz
DETAILS MAY BE SUBJECT TO CHANGE WITHOUT NOTICE
COPYRIGHT © "KLC LIMITED" ALL RIGHTS ASSERTED



| | |
|------------------------------------|--------------------------|
| DRAWING SCALE 1:2 @ A4 | ISSUE DATE 26/10/2018 |
| DRAWING No KLC CF20 VS42 | REVISION |