

LEGEND :

- |  |   |  |
|--|---|--|
| <ul style="list-style-type: none"> <li>(PEF) PEF ROD BACKING: Foam backing rod with sealant in Window perimeter that forms a waterproof air-seal. ( Sealant 2:1 Ratio )</li> <li>(AJ) ALUMINIUM JOINERY: Selected double glazed aluminium joinery</li> <li>(IL) INTERNAL LINING: Selected Internal Lining</li> <li>(BW) BUILDING WRAP: Flexible Wall Underlay, As per NZBC E2/AS1 - Table 23, In extra high wind zones, Rigid Underlay required ( 9.1.7.2 E2/AS1 )</li> <li>(CC) CAVITY CLOSURE: Cavity closure strip, positioned to give a 15mm Min drip edge to cladding</li> <li>(CB) CAVITY BATTEN: 45x20 KLC Generation II, MicroPro H3.2 FJ Cavity Batten to form a 20mm cavity</li> </ul> | <ul style="list-style-type: none"> <li>(FT1) FLASHING TAPE: Flashing tape over wrap 70mm (50 min) turn-down required in corners only. Refer to Fig. 72 of NZBC E2/AS1</li> <li>(FT2) FLEXIBLE FLASHING TAPE: Flexible flashing tape lapped over aluminium head flashing or 2nd layer of Building Wrap to taped joint or top of frame</li> <li>(TF) TIMBER FRAME: H1.2 min treated timber framing</li> <li>(WB) WEATHER BOARD: KLC Generation II, MicroPro H3.2 Bevel Back Weatherboard, Profile to NZS 3617</li> <li>(IN) INSULATION: Selected Insulation</li> <li>(HF) HEAD FLASHING: Aluminium head flashing with minimum 15 degree fall and optional hemmed edges as per table 7 E2/AS1</li> <li>(TP) TIMBER PACKER: MicroPro H3.2 Treated Packer</li> </ul> | <ul style="list-style-type: none"> <li>(SS) SILL SCRIBER: MicroPro H3.2. Horizontal batten under window as necessary to suit profile, sealant to back of sill scriber</li> <li>(WL) WINDOW LINER: As Specified ( We Recommend MicroPro H3.2 Liners &amp; Sills )</li> <li>(WH) WEATHERHEAD: MicroPro H3.2, Horizontal batten above window as necessary to suit profile, shaped to shed water, sealant to back of head scriber</li> <li>(WZ) WANZ SUPPORT: Provide window support as required by joinery manufacturer</li> <li>(WS) WINDOW SCRIBER: KLC Generation II, MicroPro H3.2 profile cut to fit weatherboard, sealant to back of scriber and 75 x 3.15mm Galvanised nail in 3mm predrilled hole. 40x18 or 65x18 depending on weatherboard size</li> </ul> |
|--|---|--|

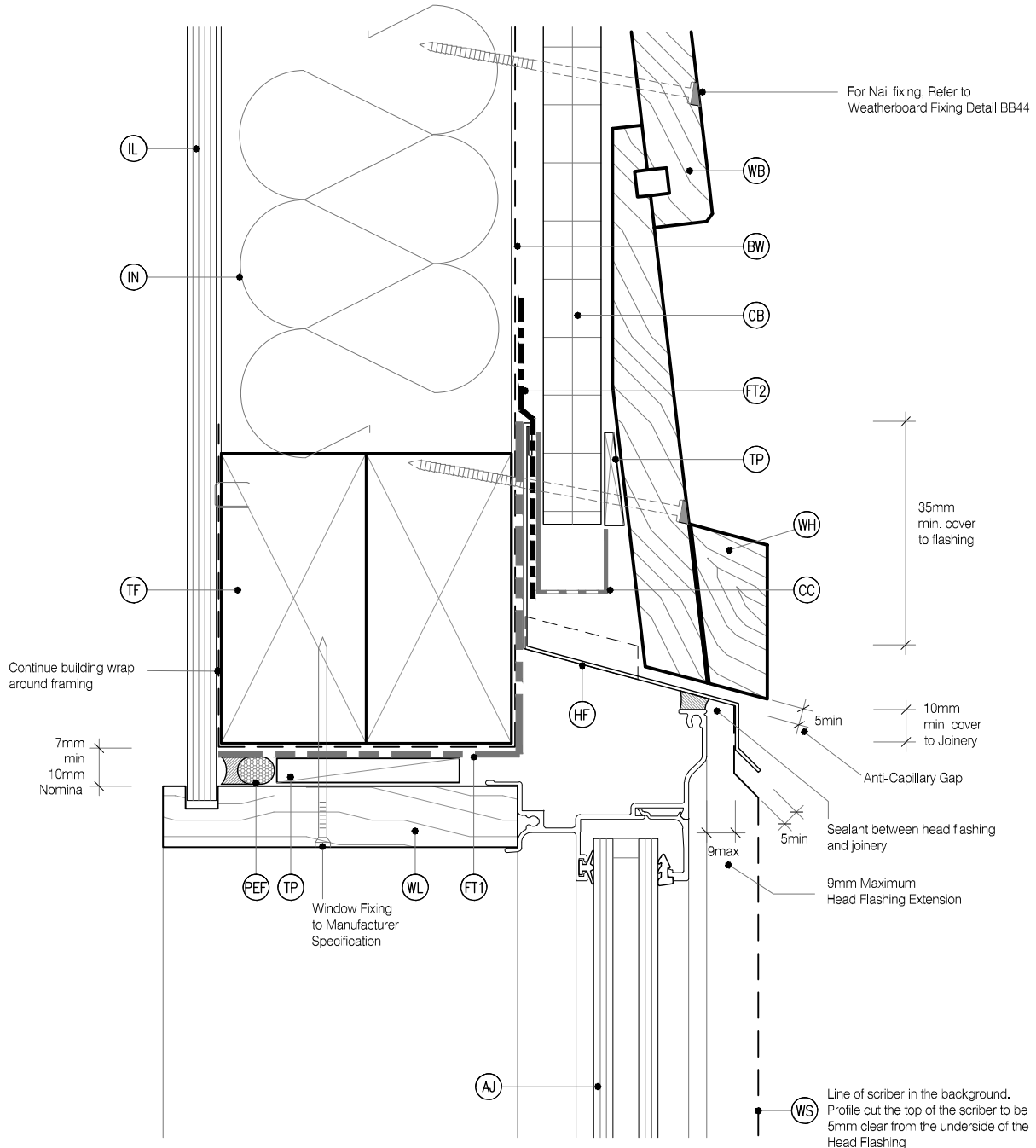

MicoPro® Wood Treatment Technology

- KLC use the MicroPro Micronized Copper Azole ( MCA ) based preservative system for their wood products. It accounts for 80% of wood treated in the US for domestic applications.
- Micronized Copper Azole ( MCA ) preservatives are EPA-approved for use in NZ and AUS to NZS3640:2003 and AS1604:12012
- MicroPro preservative is applied using high-pressure and vacuum-pressure in the impregnation process in KLC's modern, automated treatment facility.
- Cut End Treatment: All cut ends surfaces are to be double coated and sealed before fixing. With a alkyl ( oil based ) primer
- MicroPro preservative solution has benefits of reduced corrosivity. Use Hot Dip Galvanised Fasteners & Stainless Steel fasteners. MicroPro may be placed in direct contact with Aluminium Building products in interior applications, and above ground exterior applications that provide proper water drainage.
- MicroPro® is the first wood treatment process to be EPP ( Environmentally Preferable Product ) certified by Scientific Certification Systems based on a life cycle assessment.
- MicroPro® is environmentally sustainable, is low leaching, low VOC emissions and the award of the GREENGUARD Children and Schools Certification from the Greenguard® Environmental Institute.
- MicroPro® Wood Treatment Technology has received a Global GreenTag GreenRate™ Level A this declaration is 'Fit-for-Purpose' and confirmed for Green Building compliance.
- MicroPro® Wood Treatment Technology has received GreenTag PhD™ proving claims that MicroPro® is safe for human health (and ecosystems).

CAD REF :KLC CF20 BB10-15 - WINDOW DETAILS.dwg  
DATE :18/10/2018



TYPE **Generation II H3.2 Exterior Cladding Systems**  
**Bevel Back Weatherboard - Cavity Fix**

NAME **Window Head Detail - Aluminium Joinery**

[www.klc.co.nz](http://www.klc.co.nz)  
DETAILS MAY BE SUBJECT  
TO CHANGE WITHOUT NOTICE  
COPYRIGHT © KLC LIMITED ALL RIGHTS ASSERTED



DRAWING SCALE: 1:2 @ A4  
ISSUE DATE: 18/10/2018

DRAWING No	REVISION
KLC CF20 BB10	1