

LEGEND :

- | | | |
|--|--|--|
| <p>(WB) WEATHER BOARD: KLC Generation II, MicroPro H3.2 Vertical Shiplap WB. Profile to NZS 3617</p> <p>(IL) INTERNAL LINING: Selected Internal Lining</p> <p>(BW) BUILDING WRAP: Flexible Wall Underlay, As per NZBC E2/AS1 - Table 23, In extra high wind zones, Rigid Underlay required (9.1.7.2 E2/AS1)</p> <p>(IN) INSULATION: Selected Insulation</p> <p>(TF) TIMBER FRAME: H1.2 min treated timber framing</p> | <p>(CB1) CAVITY BATTEN, HORIZONTAL: 45x20 Castellated with a 18 degree bevelled slope. MicroPro H3.2 FJ. To form a 20mm cavity</p> <p>(CB2) CAVITY BATTEN, VERTICAL: 45x20 KLC Generation II, MicroPro H3.2 FJ. To form a 20mm cavity</p> <p>(MR) METAL ROOFING : Selected Metal Roofing</p> <p>(RU) ROOFING UNDERLAY: Selected Roofing Underlay As Per AS/AZS4200 with Mesh or Self Supported</p> <p>(TP) TIMBER PACKER: Cant Strip, MicroPro H3.2 Treated</p> | <p>(HS) HEAD SOFFIT SCRIBER: KLC Generation II, MicroPro H3.2. Fix with 75 x 3.15mm Galvanised nail in 2.5mm predrilled hole</p> <p>(AF) APRON FLASHING: Materials as per E2/AS1 4.0, Coating to match roofing material or refer E2/AS1 Table 21. Flashing Cover 130mm min. (L, M & H ≥ 10°) All others 200mm Refer Table 7 E2/AS1</p> <p>(SL) SOFFIT LINING: As Selected (Typically 7.5mm Hardies Soffit Liner)</p> <p>(CC) CAVITY CLOSURE: Cavity closure strip, positioned to give a 15mm Min drip edge to cladding</p> |
|--|--|--|

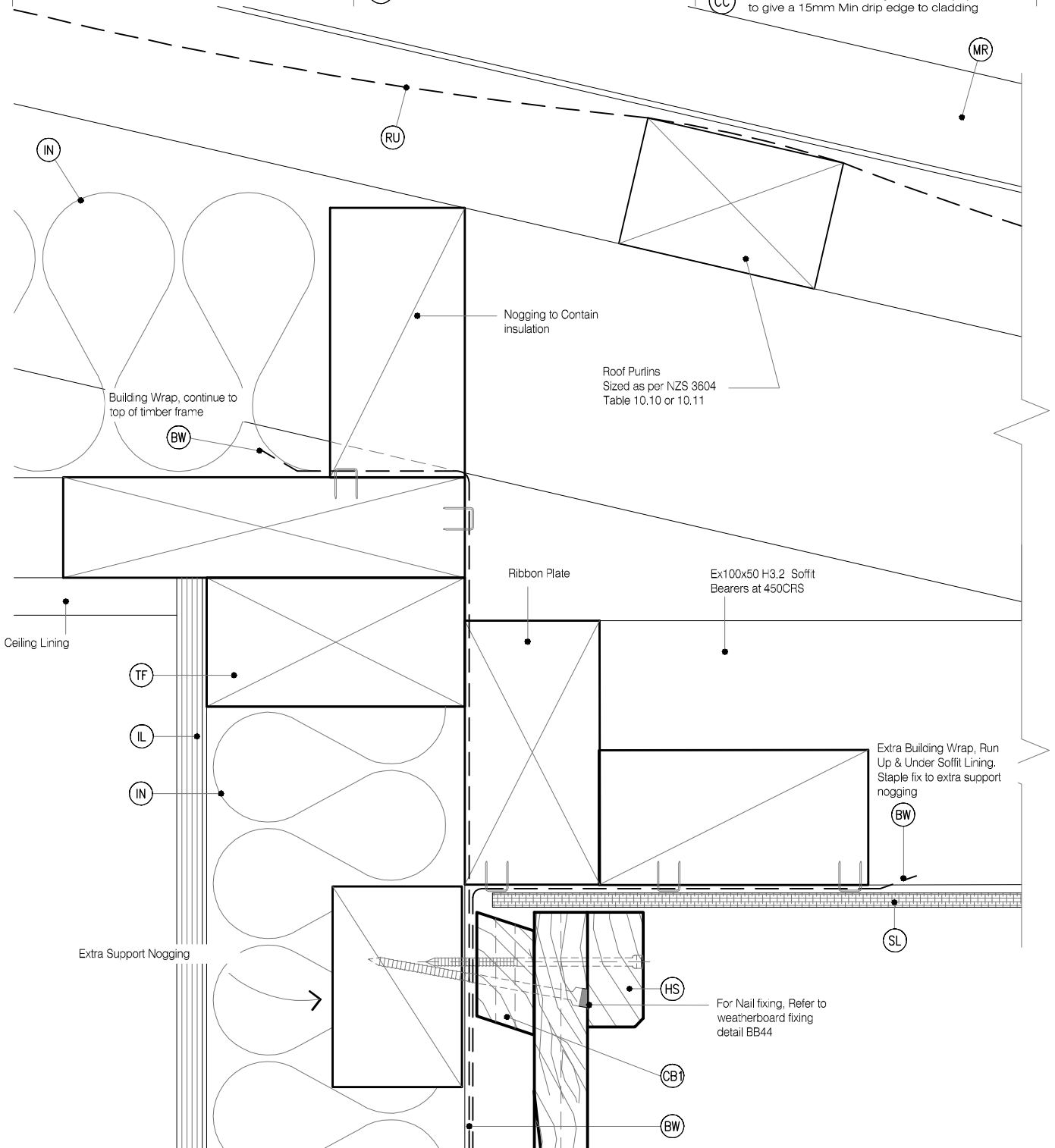

MicroPro® Wood Treatment Technology

- KLC use the MicroPro Micronized Copper Azole (MCA) based preservative system for their wood products. It accounts for 80% of wood treated in the US for domestic applications.
- Micronized Copper Azole (MCA) preservatives are EPA-approved for use in NZ and AUS to NZS3640:2003 and AS1604:12012
- MicroPro preservative is applied using high-pressure and vacuum-pressure in the impregnation process in KLC's modern, automated treatment facility.
- Cut End Treatment: All cut ends surfaces are to be double coated and sealed before fixing. With a alkylid (oil based) primer
- MicroPro preservative solution has benefits of reduced corrosivity. Use Hot Dip Galvanised Fasteners & Stainless Steel fasteners. MicroPro may be placed in direct contact with Aluminium Building products in interior applications, and above ground exterior applications that provide proper water drainage.
- MicroPro® is the first wood treatment process to be EPP (Environmentally Preferable Product) certified by Scientific Certification Systems based on a life cycle assessment.
- MicroPro® is environmentally sustainable, is low leaching, low VOC emissions and the award of the GREENGUARD Children and Schools Certification from the Greenguard® Environmental Institute.
- MicroPro® Wood Treatment Technology has received a Global GreenTag GreenRate™ Level A this declaration is 'Fit-for-Purpose' and confirmed for Green Building compliance.
- MicroPro® Wood Treatment Technology has received GreenTag PhD™ proving claims that MicroPro® is safe for human health (and ecosystems).

CAD REF :KLC CF20 VS60-06 - GENERAL DETAILS 03.dwg
DATE :25/10/2018



TYPE Generation II H3.2 Exterior Cladding Systems
Vertical Shiplap WB - Cavity Fix

NAME Soffit Detail at Wall

www.klc.co.nz
DETAILS MAY BE SUBJECT
TO CHANGE WITHOUT NOTICE
COPYRIGHT © "KLC LIMITED" ALL RIGHTS ASSERTED



DRAWING SCALE
1:2 @ A4

ISSUE DATE
26/10/2018

DRAWING No KLC CF20 VS62	REVISION
------------------------------------	-----------------